



Mastercam X² Wire



Fast. Flexible. Reliable.

You've Got The Power

Mastercam X2 Wire – Fast. Flexible. Reliable.

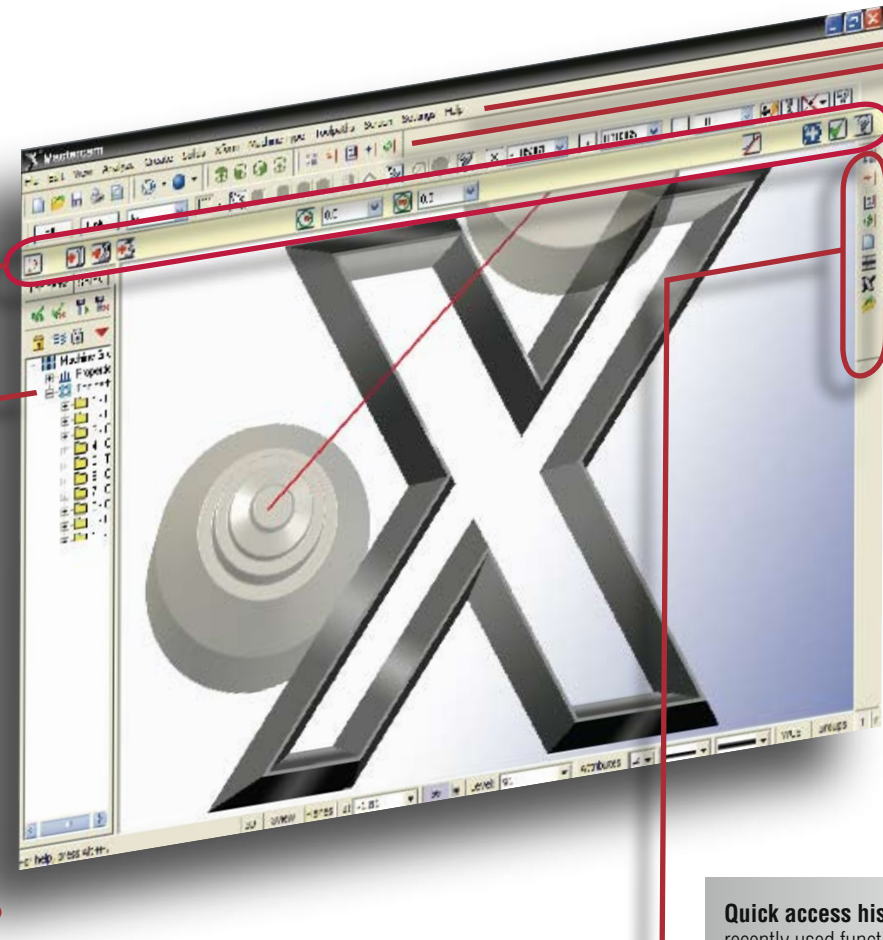

Smart Ribbon Bar automatically changes based on what you are doing.

New active Operations Manager gives dynamic access to all toolpath and solid model histories.

Quick access to basic functions gets you familiar with the toolbar icons quickly – and lets you choose from a familiar text menu.

Fully customizable interface gives you instant access to the tools you need most.

Quick access history keeps your most recently used functions at your fingertips.



CAD Tools

Logical Part Modeling

Modeling in Mastercam Wire can be as free and dynamic as a pencil sketch, or as mathematically precise as you need it to be. You can even open files directly from today's major CAD software.

CAD File Tracking and Change Recognition

Mastercam helps track engineering changes, recognizes items that have changed since you programmed the part, and even quickly updates your wirepaths.

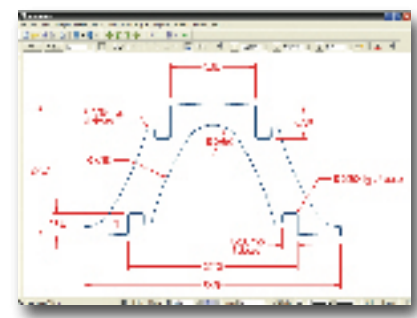

Easy, efficient CAD tools ensure quick design.

We established CNC Software, Inc. in 1983 to give shops a smarter, easier, offline method to program CNC machines. Today, Mastercam is the most commonly used CAM software worldwide* and remains the program of choice among CNC programmers. When you invest in Mastercam, you get the best in CNC programming backed by the support and service of today's leading developer and our worldwide certified Resellers. Mastercam X2 represents the next generation of our popular Mastercam X CAD/CAM software, delivering the most comprehensive wire EDM package with powerful wirepaths and techniques.

*Source: CIMdata, Inc.



CAM Tools

Powerful EDM Programming

- 2-axis contour, with or without taper angle.
- No-core cutting.
- 4-axis synchronization with automatic or manual input, and automatic skim and reverse cuts.
- 4-axis surface finish by chordal deviation.
- 4-axis interpolation support (G2/G3).
- Graphical programming with options for straight cut, tapered cut, or tapered cut with land from either direction.
- Automatic lead-in and lead-out strategies.
- Contour multiple parts using a single window selection.
- Automatic maximum taper/UV travel detection.
- Special Sharp Corner option creates an outside loop to ensure corners are not rounded off.
- Automatic wirepath corner filleting.
- Translate wirepaths for easy part repetition without creating new geometry.

- Modify control settings, corner types, and taper angles at any point in a contour.
- Define separate lead-ins and lead-outs for wirepaths with trimming of leads to improve efficiency.
- Apply tapers before or after a vertical wirepath.
- Click and dynamically drag a machining start point to anywhere on your model.
- Wirepath filtering significantly reduces the size of a program. The filter automatically turns small, multiple linear moves into single line or arc moves.

Efficient Tab Creation

- Quickly add multiple tabs to any piece of geometry.
- Automatic tabs with user definable stop types.
- 'No Drop Out' tab option helps avoid slivers.
- Tab cutoff passes can be run after each part, or after all parts are done.
- Easily create tabs on open contours.



Wirepaths

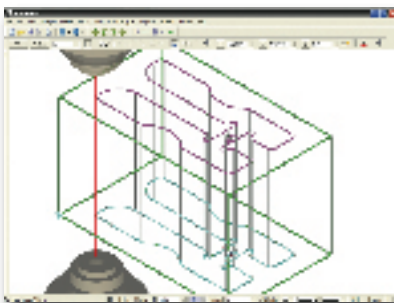

Fast 2-axis contouring.

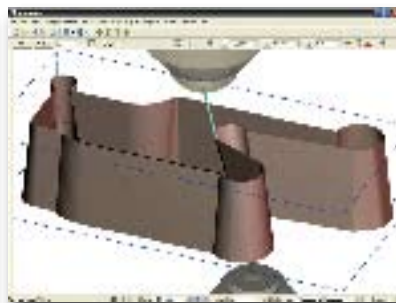

Powerful 4-axis contouring with automatic reverse and skim cuts.

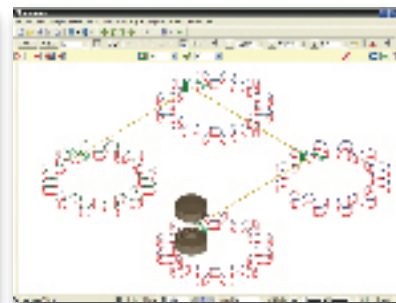

Streamline your multiple-cut jobs.

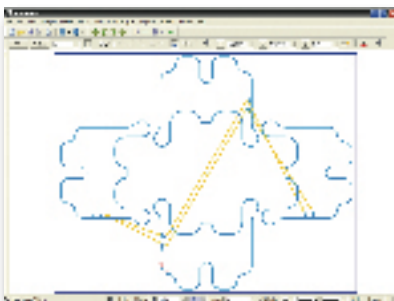

Mastercam simplifies 2- and 4-axis nested programming.

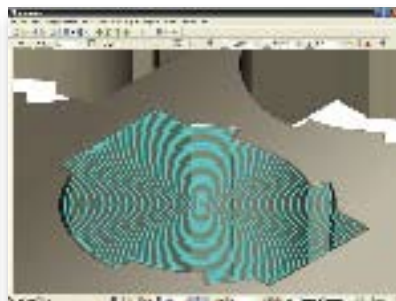

Run operations unattended with efficient no-core cutting.



Tab control makes it easy to cut multiple parts with complete control over when the tab is cut.

Capture Your Machining Knowledge

Mastercam's full associativity gives you the power to capture your work and build on your experience. Once you program a part – any part – you can modify any element of the job and immediately get updated wirepaths without starting over. You can even build a library of machining strategies, apply them to a part, and Mastercam adapts them to the new model. Fast, easy, and productive. The way programming should be.



Efficient Wirepath Management

- Mastercam's Operations Manager stores all your job's operations in one place. Quickly create, edit, and verify your wirepaths, or copy and paste parameters, wirepaths, and wire power libraries from one operation to another.
- User-customizable wire power libraries store power settings and other registers for rough and skim passes.
- Graphical wirepath editor gives you point-and-click on-screen editing tools.



Mastercam's Operations Manager is a fast, efficient way to manage your jobs.

Dependable Wirepath Verification

- Watch your part being cut from a block of material with Mastercam's solid wirepath verification.
- Step through the program with shaded wirepath backplotting.
- Dynamically view all the vital information about power settings and operations at any point in the wirepath.
- Backplot XY and UV moves in different colors for easy identification.

Other powerful CAD/CAM packages available from CNC Software:



Mastercam Mill

Industry leading milling package

Mastercam Lathe

Fast, flexible CNC turning

Mastercam Router

Quick and easy router cutting

Mastercam Art

Turn flat line art into artistic 3D work

Mastercam Solids

Powerful Parasolid® based part modeling

System Requirements

- **Processor:** 32 bit, 1.5 GHz **minimum** Intel compatible processor (64 bit Intel compatible processors are supported).
- **Operating System:** Windows® XP, Windows® XP Pro 64 bit edition or Windows 2000 with latest service packs and updates.
- .NET 2.0 framework.
- **Memory:** 512 MB RAM, 1 GB available hard disk space.
- **Graphics Card:** 64 MB OpenGL-compatible (minimum).
- **Monitor:** 1024 x 768 resolution (minimum).
- **Mouse:** Windows® compatible mouse.

Mastercam.
cnc software, inc.

671 Old Post Road Tolland, CT 06084 USA
(800) 228-2877 • Fax (860) 872-1565
www.mastercam.com • mcinfo@mastercam.com

